

L:\St. John Properties Inc\00211253.005A-SJP-Beatty-Reservoir Run\Final Deliverables\CIVIL\CADD\Drawings\20211253.005A (C-X) Private Site & Layout Plan Key.dwg Mar 30, 2026 1:15pm hmg/ghr

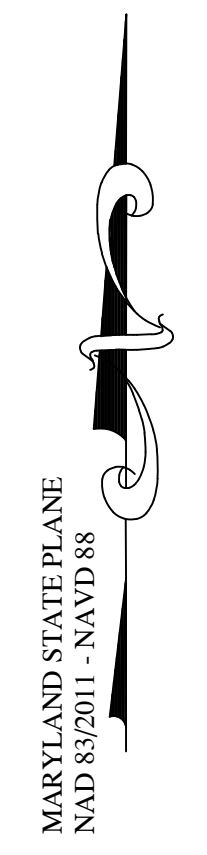
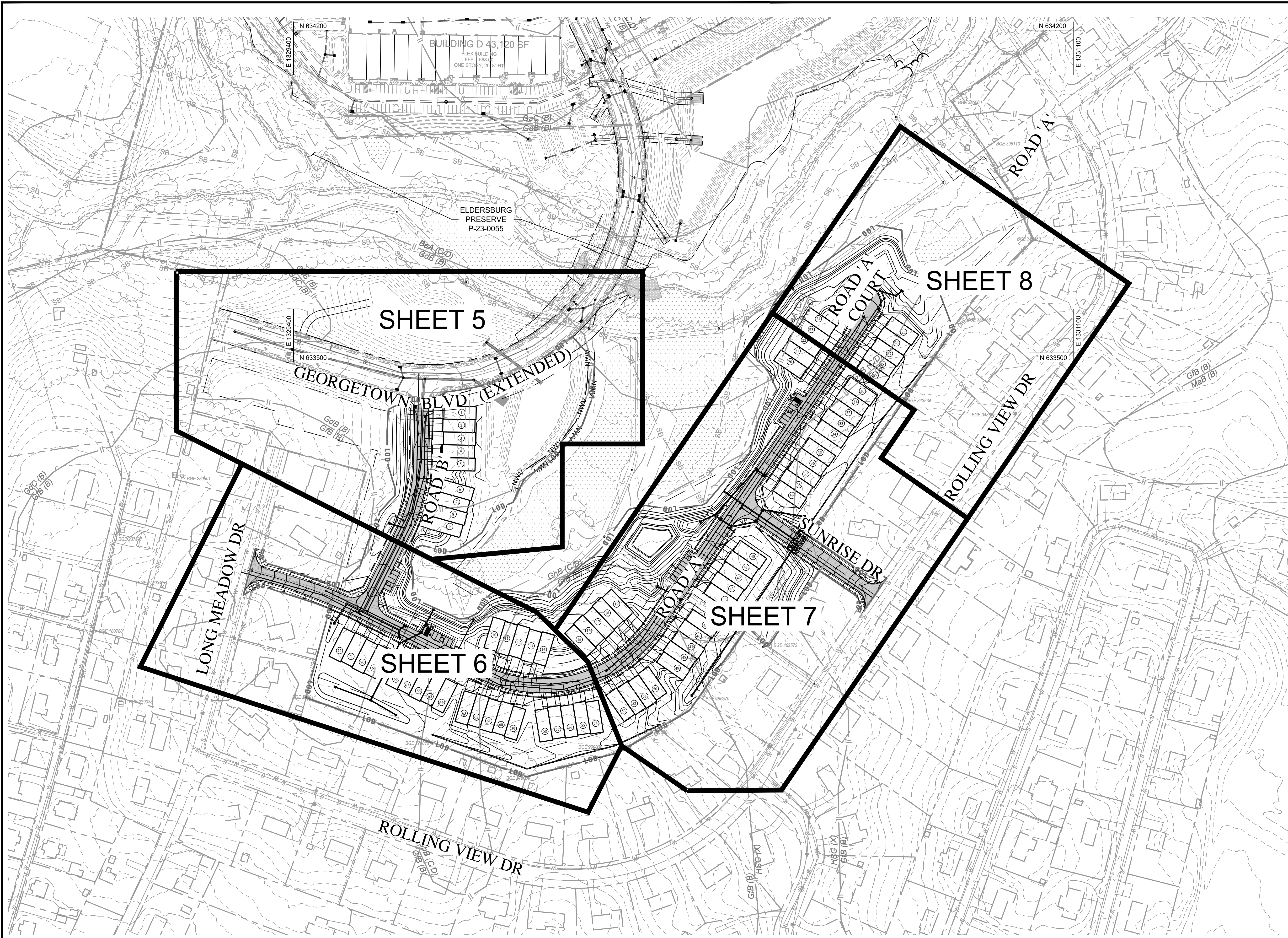

- DATA SOURCES**
- EXISTING TOPOGRAPHY AND STRUCTURES SHOWN HEREON OUTSIDE OF THE LIMITS OF FIELD RUN TOPOGRAPHY ARE FROM CARROLL COUNTY GIS.
 - EXISTING TOPOGRAPHY FROM FIELD RUN SURVEY BY MTPLS LAND SURVEYORS, LLC, DATED NOVEMBER 2021.
 - BOUNDARY INFORMATION SHOWN HEREON IS FROM FIELD LOCATION PERFORMED BY MTPLS LAND SURVEYORS, LLC, NOVEMBER, 2021.
 - COORDINATES, BEARINGS AND DISTANCES SHOWN HEREON ARE REFERRED TO THE MARYLAND STATE COORDINATE SYSTEM (NAD 83/2011, NAVD 88)
 - DOWNSTREAM CONDITIONS TAKEN FROM THE "OAK CREEK FLOODPLAIN STUDY" DATED SEPT 2009.

CENTURY ENGINEERING
 A Kleinfelder Company
 10710 Gilroy Road, Hunt Valley, MD 21031
 Phone: 443.589.2400 www.centuryeng.com

CONCEPT SITE DEVELOPMENT PLANS
 FOR 55+ RETIREMENT VILLAGE
 Site, Grading and Utility Plan Key Sheet
RESERVOIR RUN
 ELDERSBURG, MD
 TAX MAP 73 : GRID 12 : PARCEL 262
 ELECTION DISTRICT: 5 CARROLL COUNTY, MD

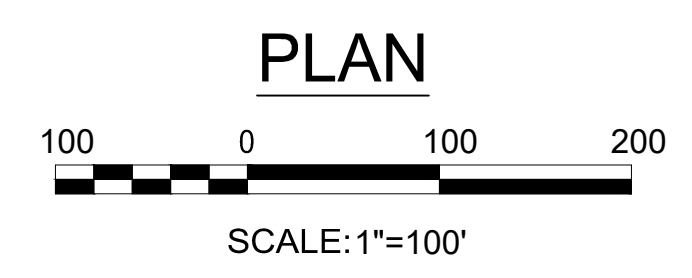

OWNER
 LONG MEADOW PARK LLC
 2560 LORD BALTIMORE DRIVE
 BALTIMORE, MD 21244
 PHONE NO: 410-369-1207

DEVELOPER
 ST. JOHN PROPERTIES, INC.
 2560 LORD BALTIMORE DRIVE
 BALTIMORE, MD 21244
 CONTACT: MATT TAYLOR
 PHONE NO: 410-369-1207

S-25-0007

DATE	BY	REVISIONS

PROFESSIONAL CERTIFICATION
 HEREBY CERTIFY THAT THESE DOCUMENTS WERE PREPARED OR APPROVED BY ME, AND THAT I AM A DULY LICENSED PROFESSIONAL ENGINEER UNDER THE LAWS OF THE STATE OF MARYLAND.
 LICENSE NUMBER: 32574
 EXPIRATION DATE: 1-16-2028